



SURVEYOR'S OFFICE

Hamilton County

Kenton C. Ward, CFM
Surveyor of Hamilton County
Phone (317) 776-8495
Fax (317) 776-9628

Suite 188
One Hamilton County Square
Noblesville, Indiana 46060-2230

March 28, 2018

To: Hamilton County Drainage Board

Re: Long Branch Drain – Woods at Shelborne Section 1, Palazzolo Reconstruction

Attached is a petition and plans for the proposed relocation of a portion of the Woods at Shelborne Section 1 Arm of the Long Branch Drain. The relocation is being proposed by Isabella Palazzolo and Basavaraj Hooli. The proposal is to replace and relocate the existing SSD across this parcel by moving it further north, closer to where the swale currently is installed.

This line will consist of the following:

104 feet of 6' SSD

The total length of the new tile shall be 104 feet. The 99 feet of the original SSD across lot 99 shall be vacated. This proposal will add a total of 5 feet to the Woods at Shelborne Section 1 Arm of the Long Branch Drain's total length.

The cost of the relocation is to be paid by Basavaraj Hooli & Isabella Palazzolo. Because the project is to be paid by the petitioner and is within the boundaries of the petitioner's property, the project falls under the requirements as set out in IC 36-9-27-52.5. Therefore, a noticed hearing is not required for the petition.

The parcels affected are as listed below:

Parcel Number	Owner
17-09-32-00-07-022.000	Basavaraj Hooli & Isabella Palazzolo

Since the entire cost of the relocation is estimated to be under \$1500.00, no bond is being submitted for the relocation/reconstruction work.

The easement for these drain reconstruction shall remain those easements shown on the secondary plat for Woods at Shelborne Section 1 as recorded in the office of the Hamilton County Recorder as instrument number 2015050827.

I recommend approval by the Board at this time.

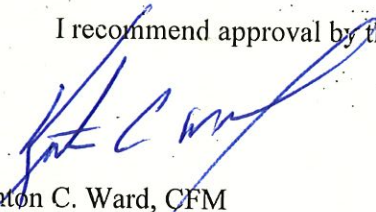

Kenton C. Ward, CFM
Hamilton County Surveyor

KCW/pll

HAMILTON COUNTY DRAINAGE BOARD
NOBLESVILLE, INDIANA

FILED
MAR 27 2018

IN RE: Long Branch Drain)
Hamilton County, Indiana)

OFFICE OF HAMILTON COUNTY SURVEYOR

PETITION FOR RELOCATION AND RECONSTRUCTION

Basavaraj V Hooli & Isabella Palazzolo (hereinafter "Petitioner"),

hereby petitions the Hamilton County Drainage Board for authority to relocate and improve a section of the Woods at Shelborne Section 1 Arm of Long Branch Drain, and in support of said petition advises the Board that:

1. Petitioner owns real estate through which a portion of the Long Branch Drain runs.
2. Petitioner plans to develop its real estate with roads, buildings, utilities, storm drains, sanitary sewers and other structures.
3. Petitioner's proposed development of its real estate will require relocation and reconstruction of a portion of the Long Branch Drain, as specifically shown on engineering plans and specifications filed with the Hamilton County Surveyor.
4. The work necessary for the proposed relocation and reconstruction will be undertaken at the sole expense of the Petitioner and such work will result in substantial improvement to the Long Branch Drain, without cost to other property owners on the watershed of the Long Broance Drain.
5. Proposed relocation and reconstruction will not adversely affect other land owners within the drainage shed.
6. Petitioner requests approval of the proposed relocation and reconstruction under IC 36-9-27-52.5.

WHEREFORE, Petitioner requests that an Order issued from the Hamilton County Drainage Board authorizing relocation and reconstruction of the Long Branch Drain, in conformance with applicable law and plans and specifications on file with the Hamilton County Surveyor.

Basavaraj Hooli

BASAVARAJ HOOLI

Isabella Palazzolo
Signed

ISABELLA PALAZZOLO
Printed



HAMILTON CO. SURVEYORS OFFICE

APPROVED

BY: *[Signature]* DATE: *[Signature]*

APR 10 2018

FILED
APR 10 2018

OFFICE OF HAMILTON COUNTY SURVEYOR

Approved where drainage plans comply with Hamilton County Regulated Drain Design Standards only and does not imply Drainage Board acceptance nor secondary plat approval

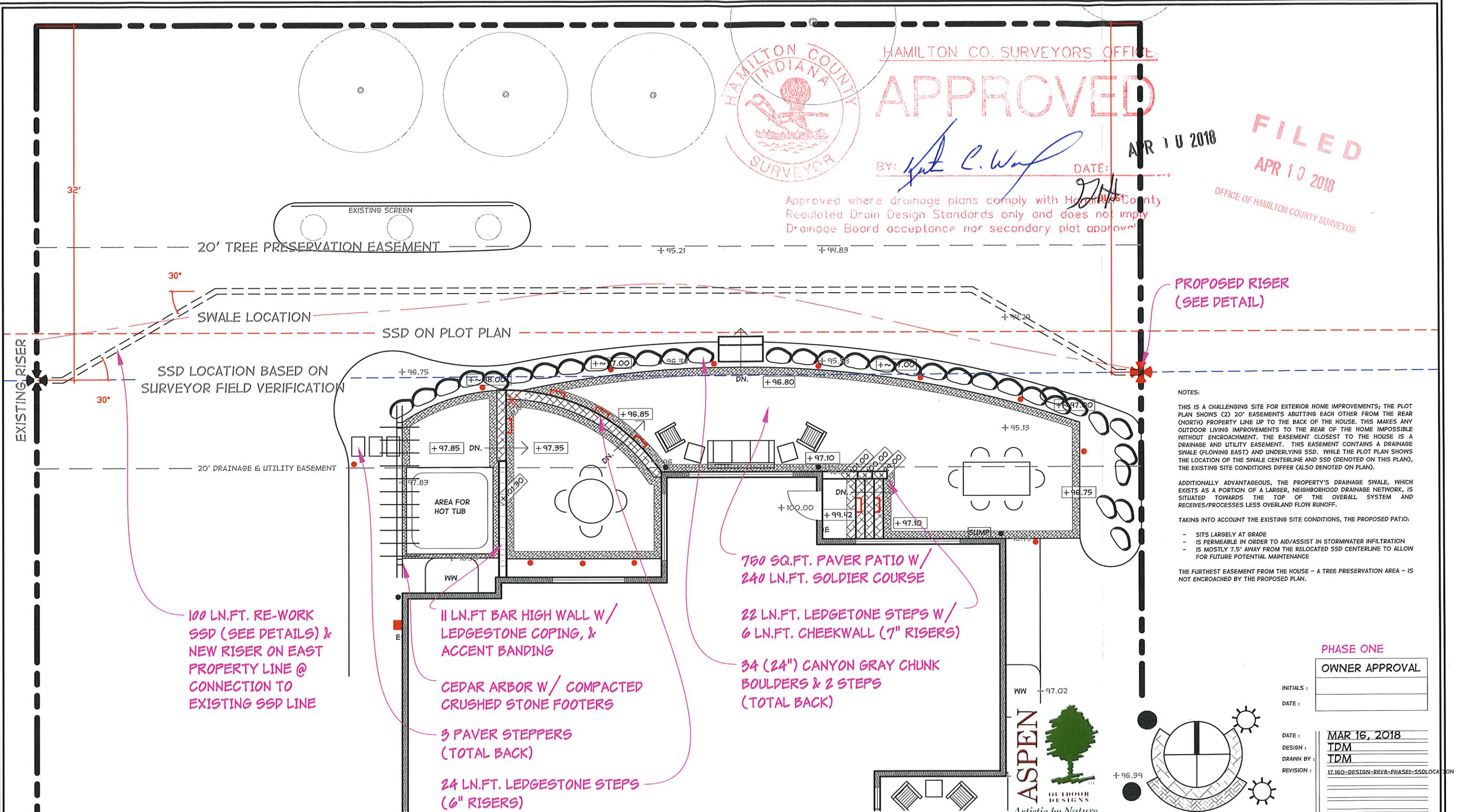

NOTES:

THIS IS A CHALLENGING SITE FOR EXTERIOR HOME IMPROVEMENTS; THE PLOT PLAN SHOWS (2) 20' EASEMENTS ABUTTING EACH OTHER FROM THE REAR (NORTH) PROPERTY LINE UP TO THE BACK OF THE HOUSE. THIS MAKES ANY OUTDOOR LIVING IMPROVEMENTS TO THE REAR OF THE HOME IMPOSSIBLE WITHOUT ENCROACHMENT. THE EASEMENT CLOSEST TO THE HOUSE IS A DRAINAGE AND UTILITY EASEMENT. THIS EASEMENT CONTAINS A DRAINAGE SWALE (FLOWING EAST) AND UNDERLYING SSD. WHILE THE PLOT PLAN SHOWS THE LOCATION OF THE SWALE CENTERLINE AND SSD (DENOTED ON THIS PLAN), THE EXISTING SITE CONDITIONS DIFFER (ALSO DENOTED ON PLAN).

ADDITIONALLY ADVANTAGEOUS, THE PROPERTY'S DRAINAGE SWALE, WHICH EXISTS AS A PORTION OF A LARGER, NEIGHBORHOOD DRAINAGE NETWORK, IS SITUATED TOWARDS THE TOP OF THE OVERALL SYSTEM AND RECEIVES/PROCESSES LESS OVERLAND FLOW RUNOFF.

TAKING INTO ACCOUNT THE EXISTING SITE CONDITIONS, THE PROPOSED PATIO:

- SITS LARGELY AT GRADE
- IS PERMEABLE IN ORDER TO AID/ASSIST IN STORMWATER INFILTRATION
- IS MOSTLY 7.5' AWAY FROM THE RELOCATED SSD CENTERLINE TO ALLOW FOR FUTURE POTENTIAL MAINTENANCE

THE FURTHEST EASEMENT FROM THE HOUSE - A TREE PRESERVATION AREA - IS NOT ENCROACHED BY THE PROPOSED PLAN.

100 LN.FT. RE-WORK SSD (SEE DETAILS) & NEW RISER ON EAST PROPERTY LINE @ CONNECTION TO EXISTING SSD LINE

11 LN.FT. BAR HIGH WALL W/ LEDGESTONE COPING, & ACCENT BANDING

CEDAR ARBOR W/ COMPACTED CRUSHED STONE FOOTERS

3 PAVER STEPPERS (TOTAL BACK)

24 LN.FT. LEDGESTONE STEPS (6" RISERS)

750 SQ.FT. PAVER PATIO W/ 240 LN.FT. SOLDIER COURSE

22 LN.FT. LEDGESTONE STEPS W/ 6 LN.FT. CHEEKWALL (7" RISERS)

34 (24") CANYON GRAY CHUNK BOULDERS & 2 STEPS (TOTAL BACK)

PHASE ONE

OWNER APPROVAL

INITIALS: _____
DATE: _____

DATE: MAR 16, 2018
DESIGN: TDM
DRAWN BY: TDM
REVISION: 17.160-DESIGN-REV8-PHASE1-SSDLOCATION

PALAZZOLO

17.160

LANDSCAPE DEVELOPMENT PLAN
PALAZZOLO RESIDENCE
3350 SHELBORNE WOODS PARKWAY CARMEL, INDIANA

© 2017, ASPEN OUTDOOR DESIGNS, INC.

ASPEN
OUTDOOR DESIGNS
Artistic by Nature
ASPEN OUTDOOR DESIGNS, INC.
11010 E. 156TH ST.
NOBLESVILLE, IN 46060
TEL: 317.774.0156
FAX: 317.776.3570
WWW.ASPENOUTDOORDESIGNS.COM

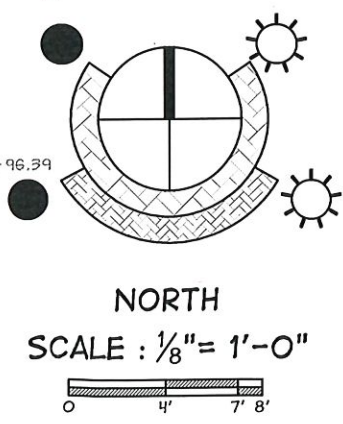



HAMILTON CO. SURVEYORS OFFICE
APPROVED
FILED

BY: *[Signature]* DATE: **APR 10 2018**
APR 10 2018

Approved where drainage plans comply with Hamilton County Regulated Drain Design Standards only and does not imply Drainage Board acceptance nor secondary plat approval.

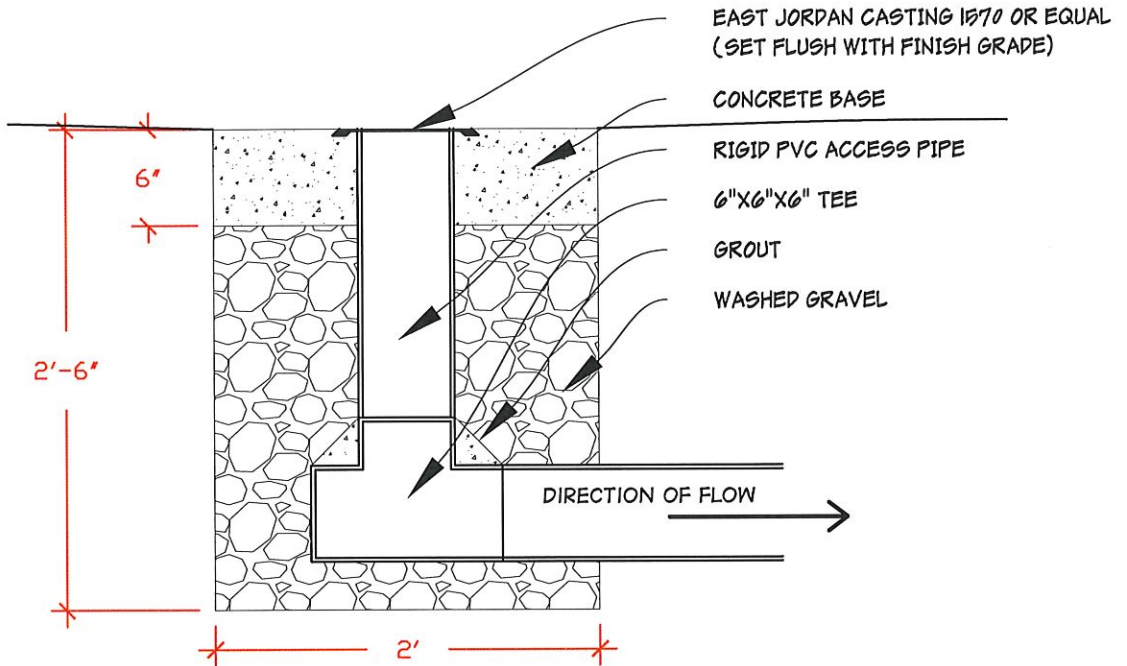

A SUBSURFACE DRAIN (SSD) RISER DETAIL
SCALE: 1" = 1'-0"

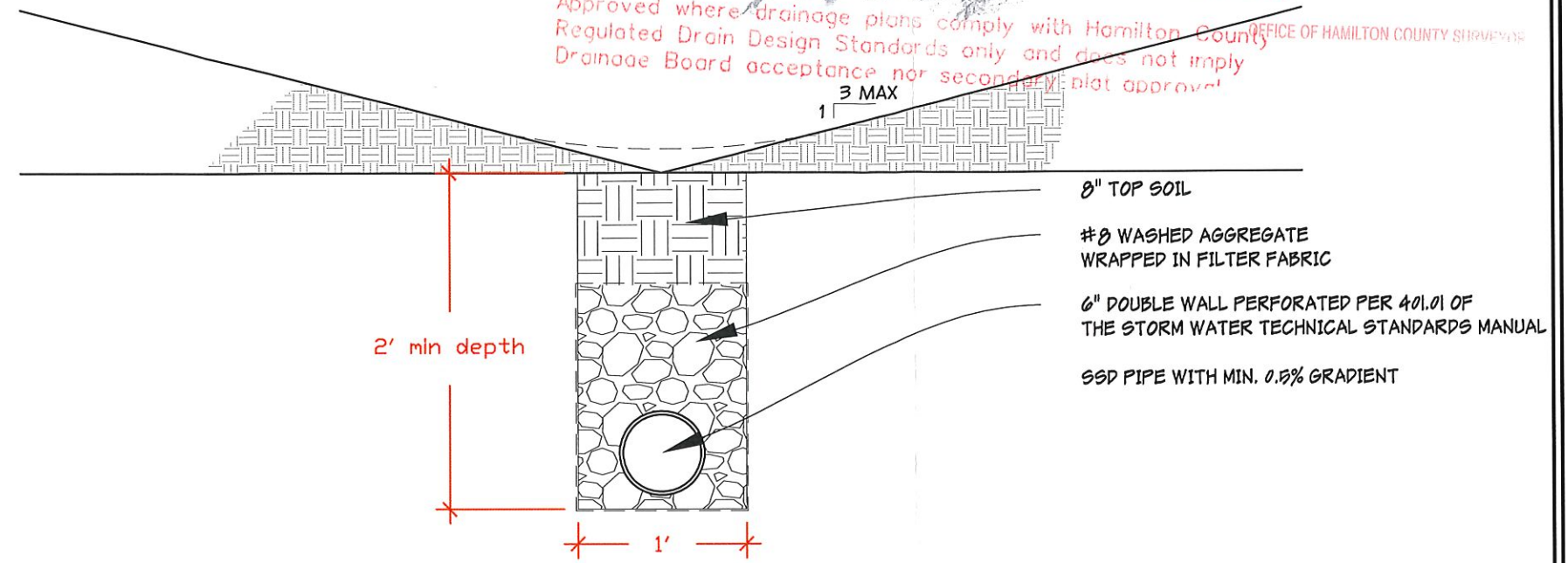

B SSD DETAILS
SCALE: 1" = 1'-0"

LANDSCAPE DEVELOPMENT PLAN
PALAZZOLO RESIDENCE
3350 SHELBORNE WOODS PARKWAY CARMEL, INDIANA

© 2017, ASPEN OUTDOOR DESIGNS, INC.

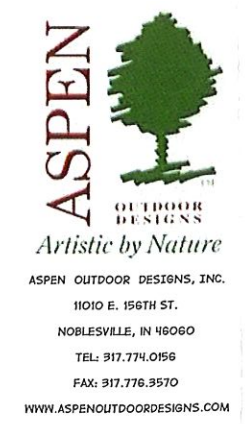

PHASE ONE
OWNER APPROVAL
INITIALS :
DATE :

DATE : **MAR 16, 2018**
DESIGN : **TDM**
DRAWN BY : **TDM**
REVISION : **17.160-DESIGN-REV8-PHASE1-SSDLOCATION**
PALAZZOLO
17.160

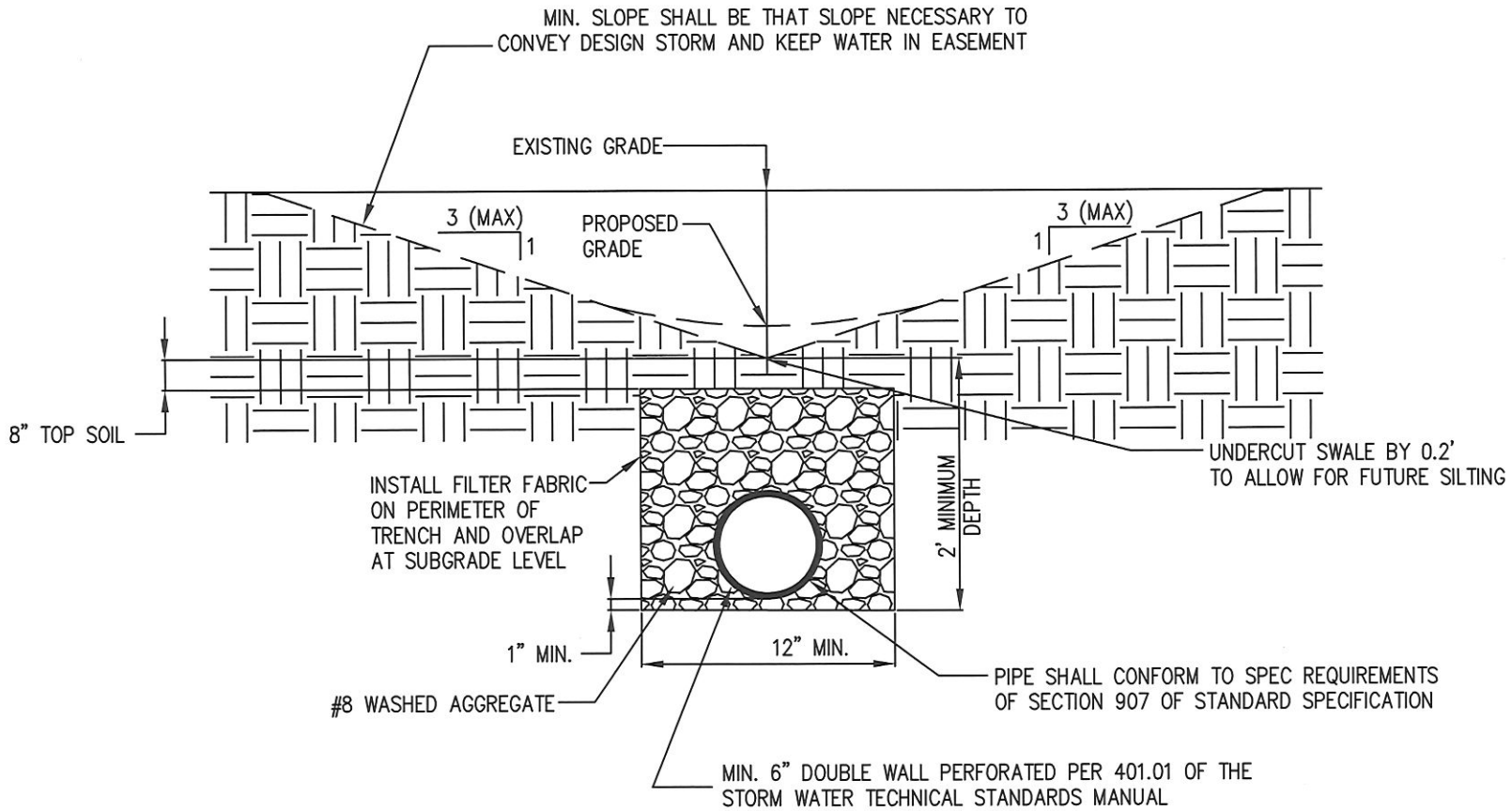

TYPICAL SWALE DETAIL

NO SCALE

CITY OF CARMEL STANDARDS

TYPICAL SWALE DETAILS

STANDARD
DRAWING
10-30

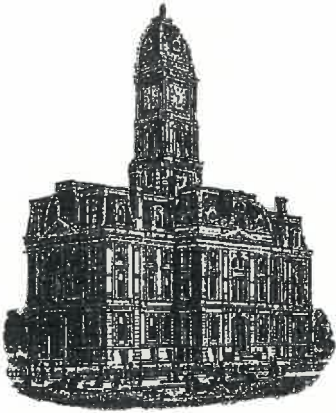

Kenton C. Ward, CFM
Surveyor of Hamilton County
Phone (317) 776-8495
Fax (317) 776-9628

Suite 188
One Hamilton County Square
Noblesville, Indiana 46060-2230

To: Hamilton County Drainage Board

October 25, 2023

Re: Long Branch Drain: Woods at Shelborne Sec. 1 – Palazzolo Reconstruction

Attached are as-built, certificate of completion & compliance, and other information for Palazzolo Reconstruction. An inspection of the drainage facilities for this section has been made and the facilities were found to be complete and acceptable.

During construction, changes were made to the drain, which will alter the plans submitted with my report for this drain-dated March 28, 2018. The report was approved by the Board at the hearing held April 9, 2018. (See Drainage Board Minutes Book 18, Pages 93-94) The changes are as follows: the 6" SSD was lengthened from 104 feet to 105 feet. The length of the drain due to the changes described above is now **105 feet**. It should be noted that this project removed 101 feet of existing 6" SSD.

The project was constructed within existing drain easement. The project was paid for by the petitioner. A surety was not requested as the project was estimated to cost less than \$1500.00.

I recommend the Board approve the drain's construction as complete and acceptable.

Sincerely,



Kenton C. Ward, CFM
Hamilton County Surveyor

HAMILTON COUNTY SURVEYOR'S OFFICE
"AS-BUILT" RECORD DRAWING
LONG BRANCH REGULATED DRAIN
(WOODS AT SHELBORNE SECTION 1 ARM)
LOT 99 WOODS AT SHELBORNE - SECTION 1

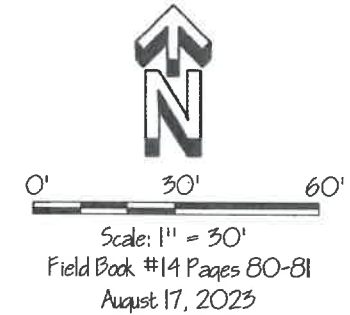
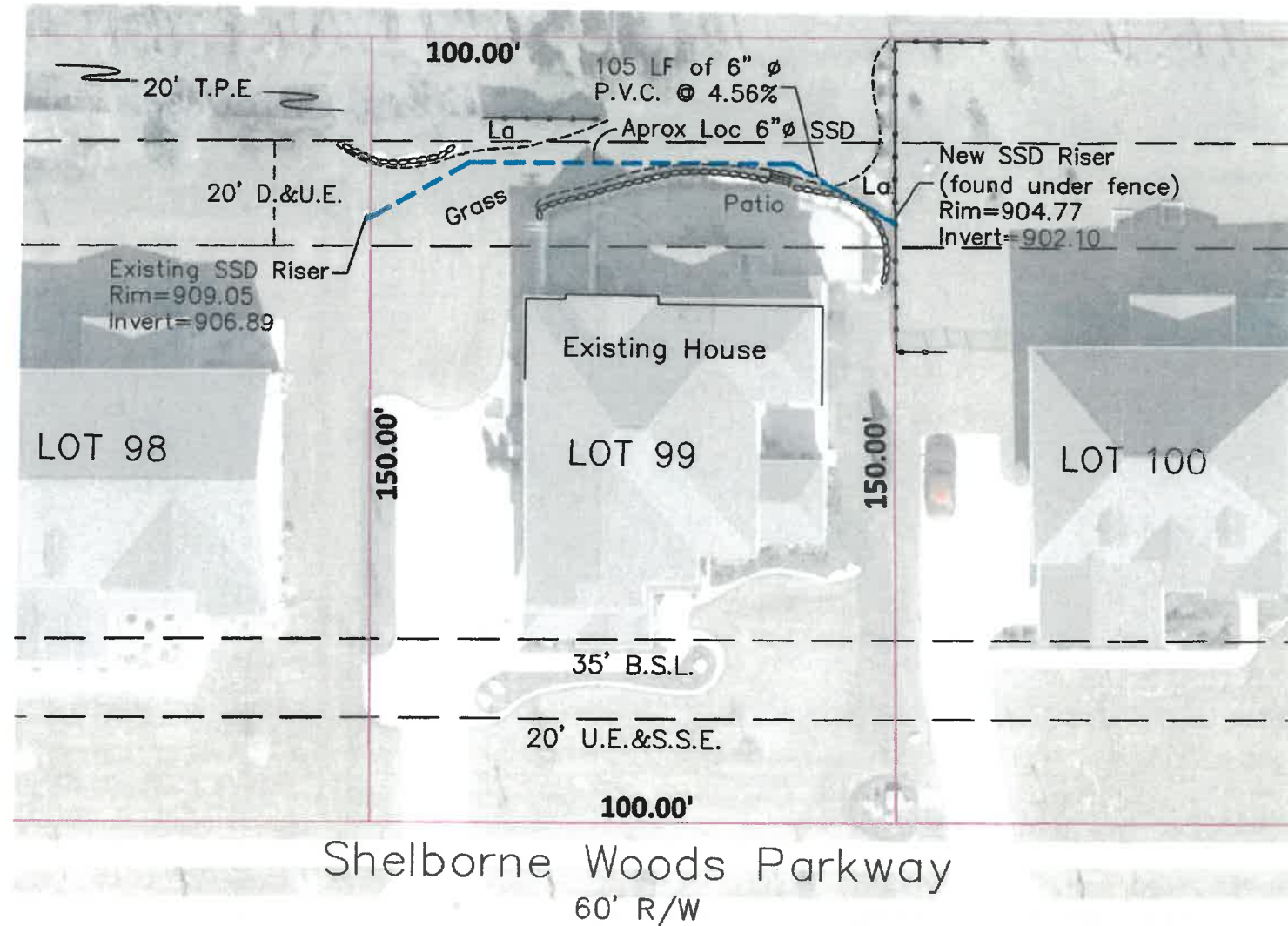

Drawn By: Teresa Dudley
 DATE: 08-18-2023

THE AS-BUILT SURVEY USED THE FOLLOWING DATUM:
 HORIZONTAL DATUM: NAD 1983 INDIANA EAST 1301 US SURVEY FOOT
 VERTICAL DATUM: (NAVD 88) (GEOID 18)

"AS-BUILT" CERTIFICATION

"AS BUILT" INFORMATION COLLECTED BY HAMILTON COUNTY SURVEYOR'S OFFICE. I HEREBY CERTIFY TO THE BEST OF MY KNOWLEDGE AND BELIEF, A TRUE AND CORRECT REPRESENTATION OF THE LOCATIONS AND ELEVATIONS OF THE "AS-BUILT" REGULATED DRAIN IMPROVEMENTS. INFORMATION OBTAINED BY FIELD SURVEY ON 08/17/2023

CERTIFIED BY:

BRIAN K. RAYL, PS
 PROFESSIONAL SURVEYOR
 INDIANA LICENSE NO. 20100070

DATE: August 19, 2023



THIS DRAWING IS NOT INTENDED TO BE REPRESENTED AS A RETRACEMENT OR ORIGINAL BOUNDARY SURVEY, A ROUTE SURVEY, OR SURVEYOR LOCATION REPORT

LEGEND

- = Existing Subsurface Drain
- = Lot Line
- = Easement Line
- D.U. & S.S.E.** = Drainage, Utility, and Sanitary Sewer Easement
- D. & U.E.** = Drainage and Utility Easement
- B.S.L.** = Building Setback Line
- T.P.E.** = Tree Preservation Easement
- = Landscape Stones
- La** = Landscape Area
- = Fence Line



HAMILTON COUNTY, INDIANA
 HAMILTON COUNTY SURVEYOR'S OFFICE
 HAMILTON COUNTY GOVERNMENT AND JUDICIAL CENTER
 ONE HAMILTON COUNTY SQUARE, SUITE 188
 NOBLESVILLE, IN 46060
 PHONE: (317) 776-8495
 FAX: (317) 776-9628
 SURVEYOR@HAMILTONCOUNTY.IN.GOV

This information was gathered for input into the Hamilton County Geographic Information System (GIS). This document is considered an official record of the GIS.
 Entry Date: 2023
 Entered By: SLM

S:\E-SURV\PROJECTS\REGULATED DRAINS\LONG BRANCH DRAIN\PALAZZOLO RECONSTRUCTION\DWG\As_Built_Woods at Shelborne sec 1 arm.dwg